

MERSEY GATEWAY BRIDGE

NORTH TOWER

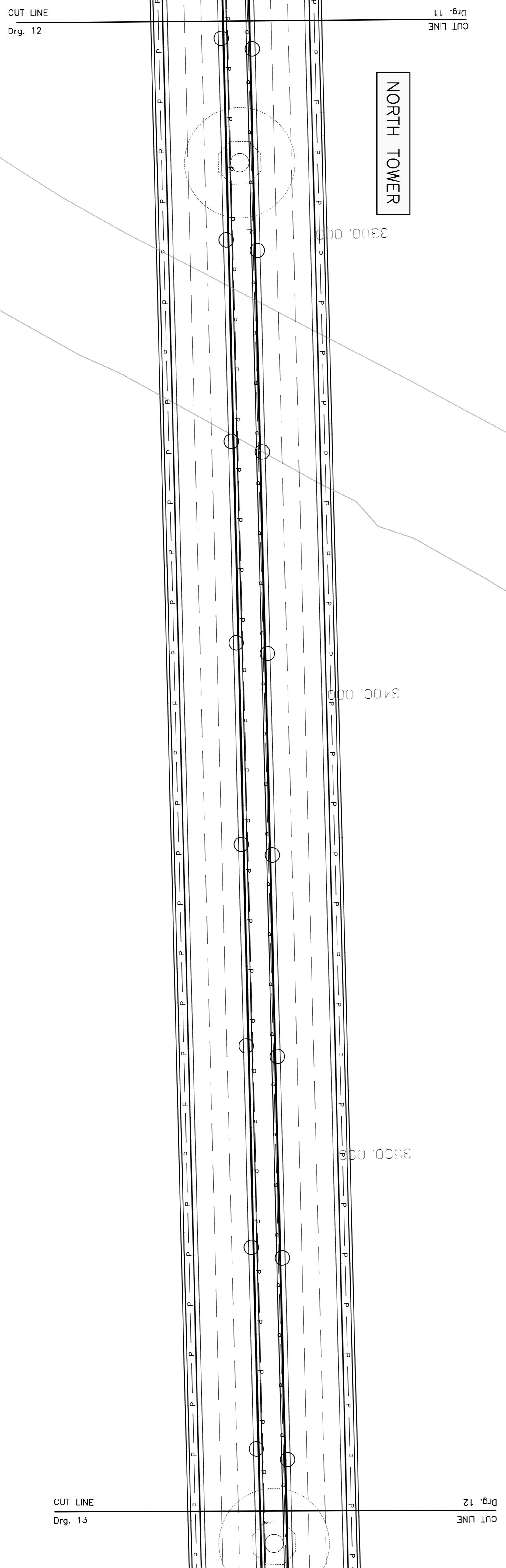

NOTES

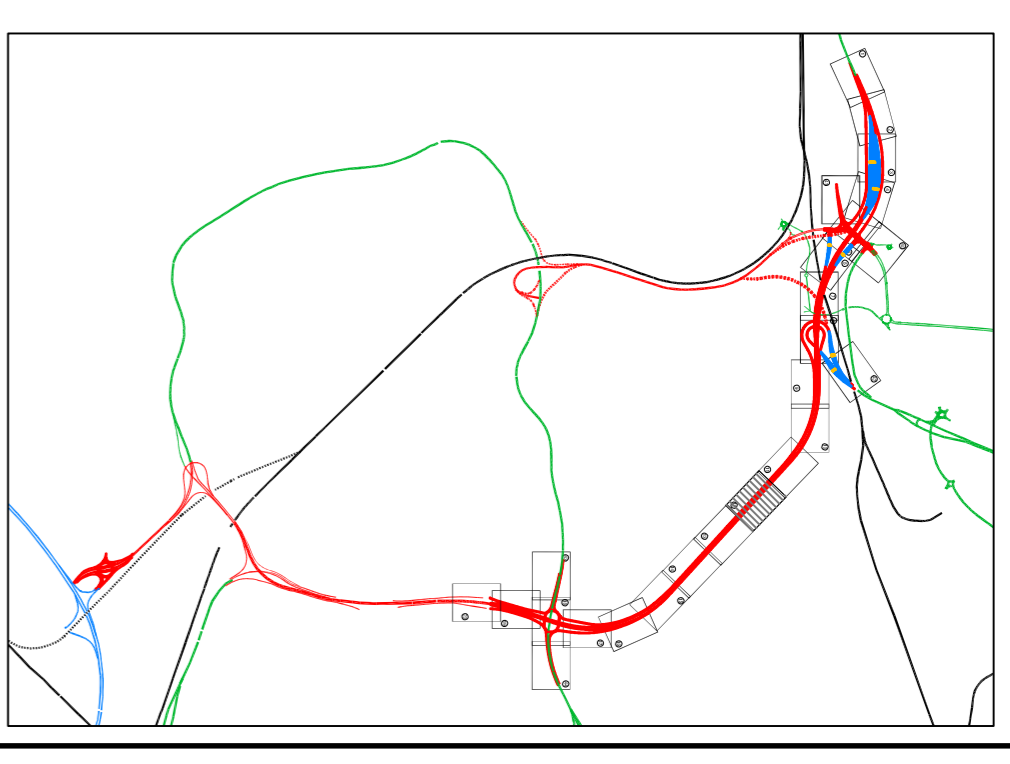

1. This drawing should only be read in relation to the subject of the title. Other information shown on drawing is to be considered indicative only. Reference should be made to appropriate drawing series for other information.
2. Do not scale from this drawing.
3. Balancing pond details to be confirmed.
4. Extent of embankments are indicative only.

Legend

- Boundary fencing
- Single sided barrier
- Parapet
- Vertical concrete barrier
- Twin lighting column
- Single lighting column
- Balancing pond
- Redundant Carrivageway and removal
- Footway/cycleway
- TMA boundary
- Planning application boundary

Rev.	Description
1	Drawn BAH
2	Chkd. JMB
3	Apprvd. SWJ
4	Date 16.05.08

PLANNING DIRECTION

- Footway/cycleway
- TMA boundary
- Planning application boundary



Project
**THE RIVER MERSEY
 (MERSEY GATEWAY BRIDGE)
 ORDER**

Drawing Title
**PLANNING DIRECTION
 GENERAL ARRANGEMENT
 SHEET 12 OF 25**

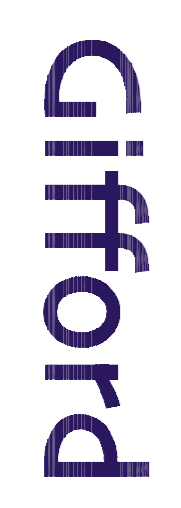

20 Nicholas Street, Chester, CH1 2NX
 Tel: 01244 31985 Fax: 01244 31950 www.gifford.com

Scale (at A1)	Date	Drawn	BAH
1:500	March 08		

Dwg. no.
B4027/4/H/100/12

10 0 10 20 50
 100mm NATURAL SCALE

This map is reproduced from Ordnance Survey material with the permission of Ordnance Survey on behalf of the Controller of Her Majesty's Stationery Office copyright. Unauthorised reproduction of this map in any form or by any means without the prior written permission of Ordnance Survey is prohibited. Licence No. 10001852/2008. Worthington Borough Council Licence No. LA079889/2002.