

1. This drawing should only be read in relation to the subject of the title. Other information shown on drawing is to be considered indicative only. Reference should be made to appropriate drawing series for other information.

**Site Plan**

**KEY**

- Centreline of scheduled work
- ..... Centreline of temporary work
- Limit of scheduled work
- Limit of deviation
- Limits of land to be acquired or used
- A1 Point of access
- Authorised location for permanent works in the River Mersey

Client



**THE RIVER MERSEY  
(MERSEY GATEWAY BRIDGE)  
ORDER**

**TRANSPORT AND WORKS  
ACT 1992  
WORKS PLANS  
SHEET 3 OF 5**

**Gifford**

20 Nicholas Street, Chester, CH1 2NX  
Tel: 01244 31855 Fax: 01244 31859 www.gifford.com

Scale (at A1)	Date	Drawn
1:2500	May 08	BAH

Dwg no. **B4027/4/TWA/100/03**

Rev.

10 0 10 20 50 100mm NATURAL SCALE

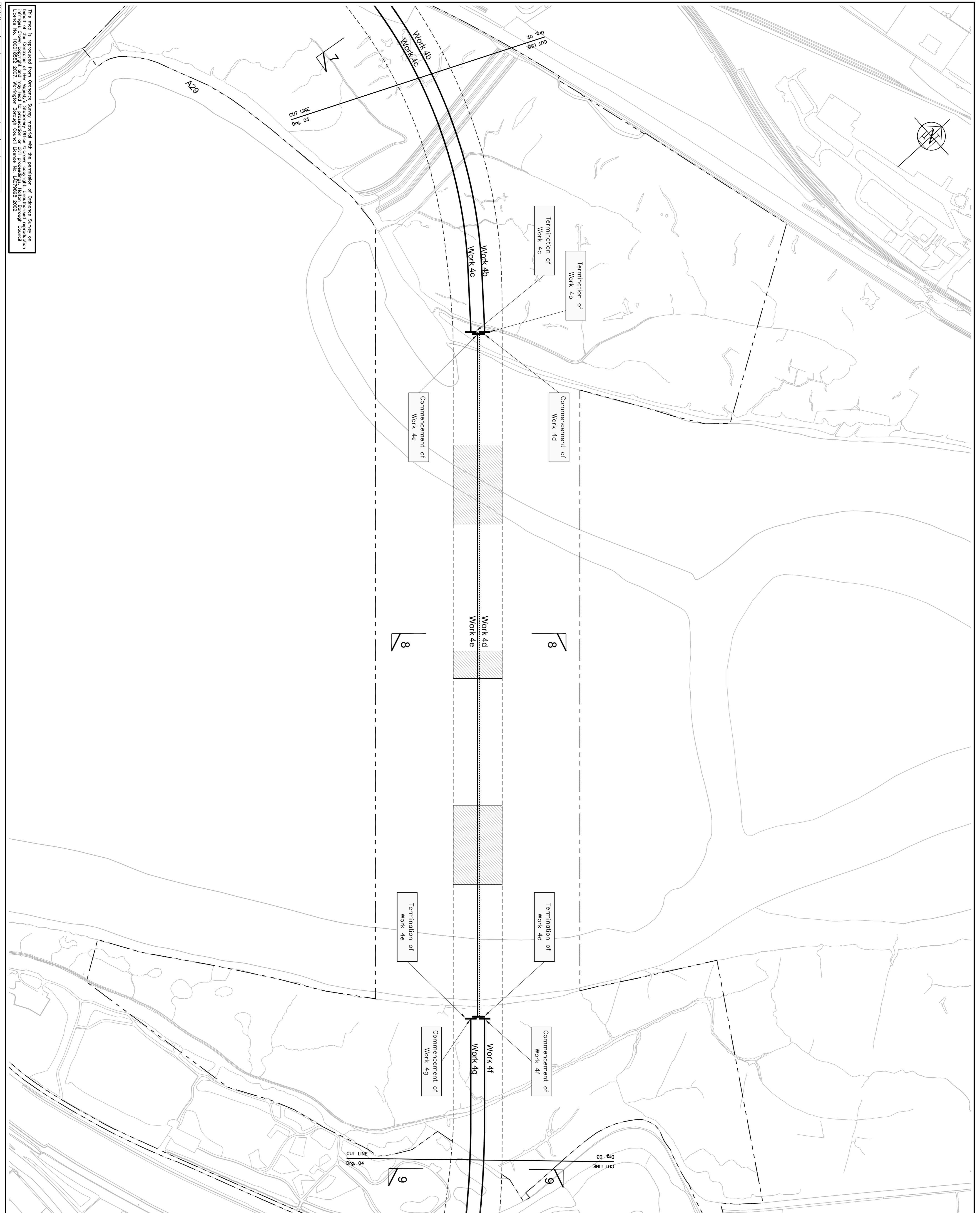

This map is reproduced from Ordnance Survey material with the permission of Ordnance Survey on behalf of the Controller of Her Majesty's Stationery Office. Crown copyright. Unauthorised reproduction is prohibited. Ordnance Survey, 2007. Licence No. 100018525. 2007. Warrington Borough Council Licence No. LA073889. 2002.