

**MERSEY GATEWAY BRIDGE  
NORTH APPROACH VIADUCT**

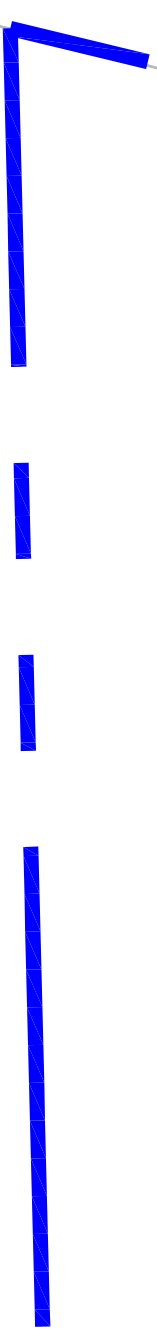

**NOTES**

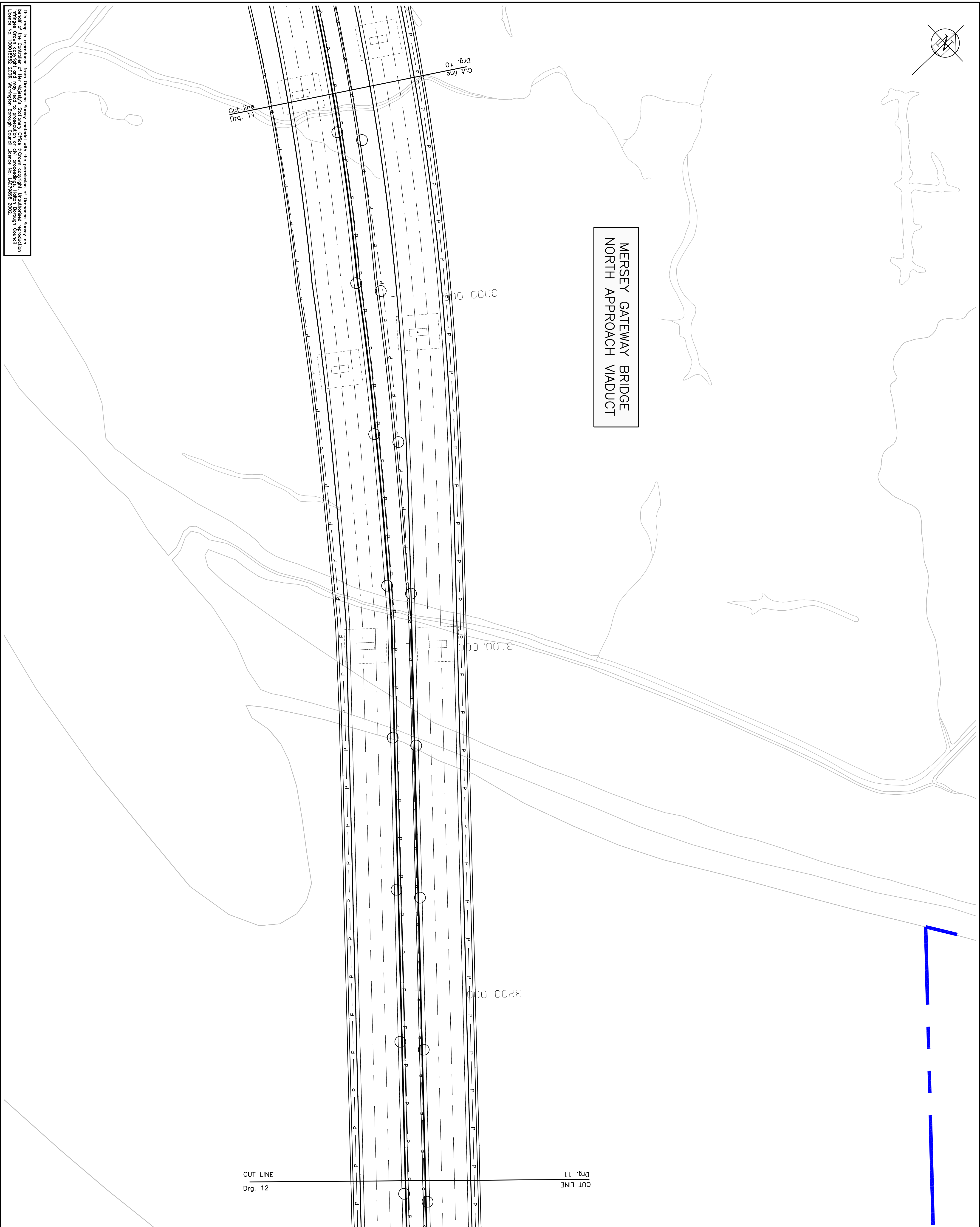
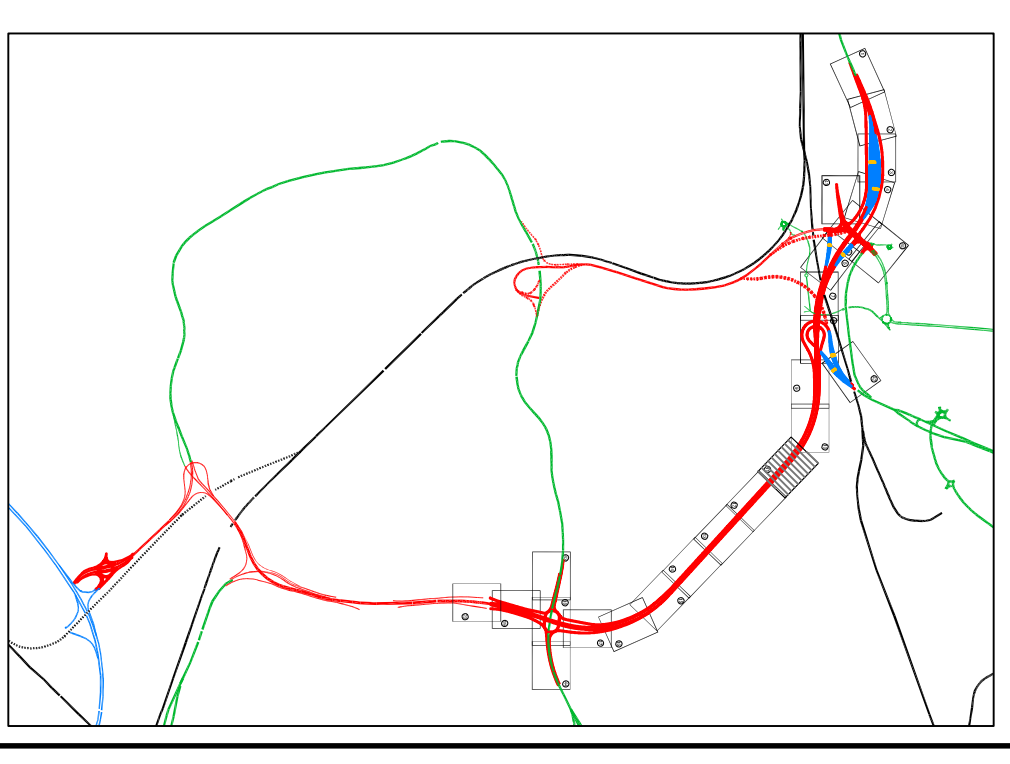

1. This drawing should only be read in relation to the subject of the title. Other information shown on drawing is to be considered indicative only. Reference should be made to appropriate drawing series for other information.
2. Do not scale from this drawing.
3. Balancing pond details to be confirmed.
4. Extent of embankments are indicative only.

**Legend**

- Boundary fencing
- Single sided barrier
- Parapet
- Vertical concrete barrier
- Twin lighting column
- Single lighting column
- Balancing pond
- Redundant Corrigeway and removal
- Footway/Cycleway
- TMA boundary
- Planning application boundary

Rev.	Description
Drawn	BAH
Chkd.	JMB
Apprvd.	SWJ
Date	16.05.08

**PLANNING DIRECTION**

- Footway/Cycleway
- TMA boundary
- Planning application boundary



**Project**  
THE RIVER MERSEY  
(MERSEY GATEWAY BRIDGE)  
ORDER

**Drawing Title**  
PLANNING DIRECTION  
GENERAL ARRANGEMENT  
SHEET 11 OF 25



20 Nicholas Street, Chester, CH1 2NX  
Tel: 01244 31985 Fax: 01244 31650 www.gifford.com

Scale (at A1)	Date	Drawn
1:500	March 08	BAH

Dwg. no.	Rev.
B4027/4/H/100 /11	-

ORIGINAL DRAWING SIZE 841 x 594

10 0 10 20 50  
100mm NATURAL SCALE

This map is reproduced from Ordnance Survey material with the permission of Ordnance Survey on behalf of the Controller of Her Majesty's Stationery Office. Copyright, Unauthorised reproduction of this map is prohibited. Ordnance Survey is a registered trademark of Ordnance Survey Limited. Licence No. 100018562 2008. Warrington Borough Council Licence No. LA079898 2002.